

Instant Road

Parameters **Make Island or Median**

In each of the examples, a different setting or group of settings is chosen. The corresponding result is shown on the right.

(If you're not using the Pro version, curb width is limited to 6 inches (15cm))

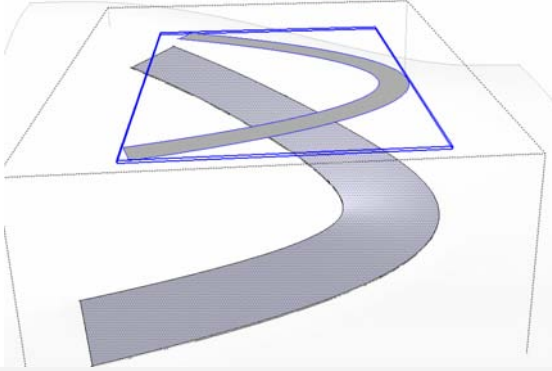

To try out these parameter settings, make a road surface and a horizontal face in the shape of the center median. The road surface must be active and the face must be in a group.

Select the group plus the road surface and choose Choose **“Plugins/Instant Road / Make Island or Median”**.

Type of Island or Median: Raised Curb or Sidewalk

Make Island or Median	<input type="button" value="X"/>
Type of Island or Median:	Raised Curb or Sidewalk
Edit Additional Parameters?	yes
<input type="button" value="OK"/>	<input type="button" value="Cancel"/>

Top of Curb above or below median +/- : 4

Curb or Sidewalk Parameters	<input type="button" value="X"/>
Curb Height	6"
Curb or sidewalk Width	6"
Median Height or Depression +/-	4
Merge with road surface?	no
if 'yes', enter Merging Width	1'
Break median at breaks in road surface?	No - use edge breaks in outline face
Smooth bumps?	no
<input type="button" value="OK"/>	<input type="button" value="Cancel"/>

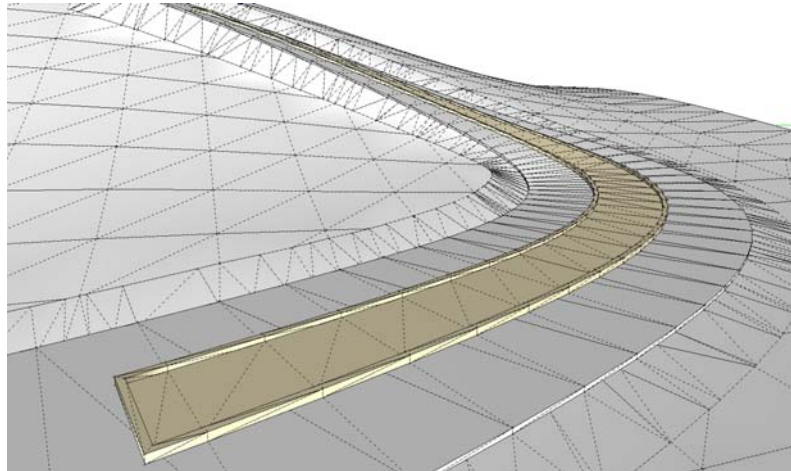

Top of Curb above or below median +/- : -24

Curb or Sidewalk Parameters	<input type="button" value="X"/>
Curb Height	6"
Curb or sidewalk Width	6"
Median Height or Depression +/-	-24
Merge with road surface?	no
if 'yes', enter Merging Width	1'
Break median at breaks in road surface?	No - use edge breaks in outline face
Smooth bumps?	no
<input type="button" value="OK"/>	<input type="button" value="Cancel"/>

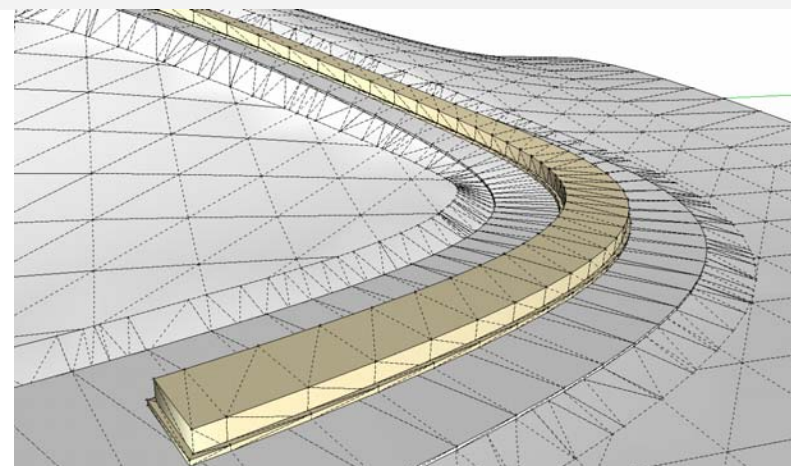

Curb or sidewalk Width : 36

Curb or Sidewalk Parameters

Curb Height	6"
Curb or sidewalk Width	36
Median Height or Depression +/-	-1"
Merge with road surface?	no
if 'yes', enter Merging Width	1'
Break median at breaks in road surface?	No - use edge breaks in outline face
Smooth bumps?	no

OK Cancel

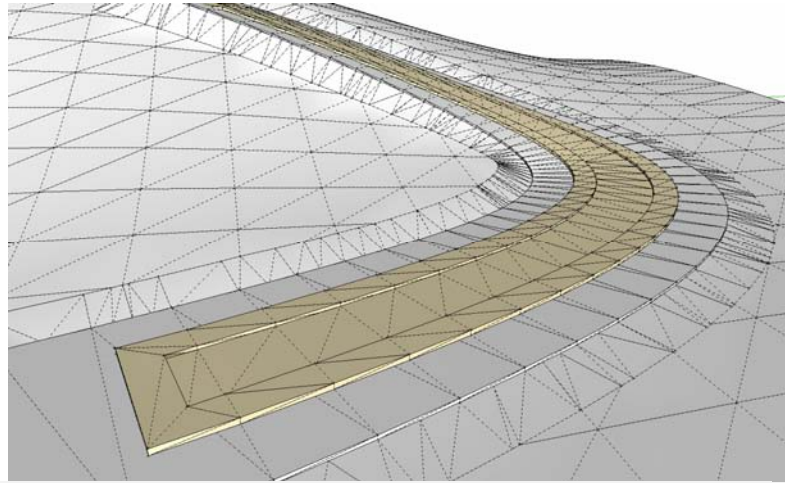

Type of Island or Median: no curb, Depressed Median

Make Island or Median

Type of Island or Median:	no curb, Depressed Median
Edit Additional Parameters?	yes

OK Cancel

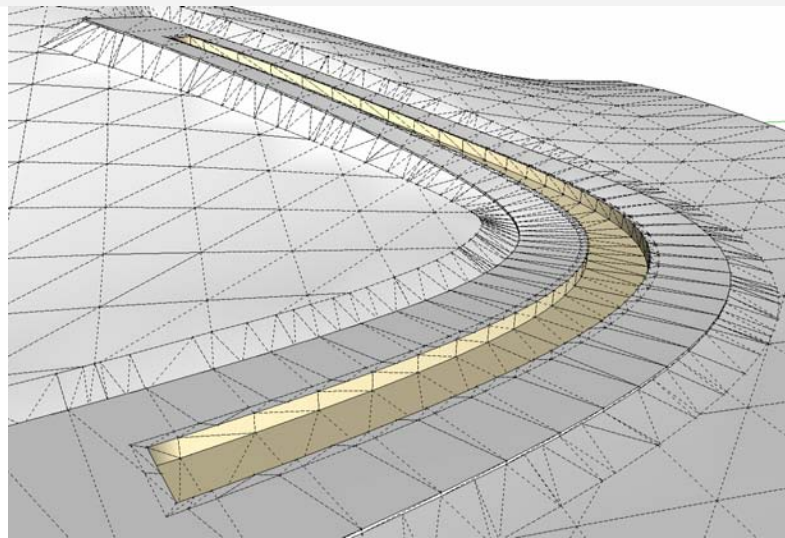

Median Depression : 24

Depressed Median Parameters

Median Depression:	24
Width of Merging with road surface	1'
Break median at breaks in road surface?	No - use edge breaks in outline face
Smooth bumps?	no

OK Cancel

Type of Island or Median : no curb, Raised Median

Make Island or Median

Type of Island or Median:	no curb, Raised Median
Edit Additional Parameters?	yes

OK Cancel

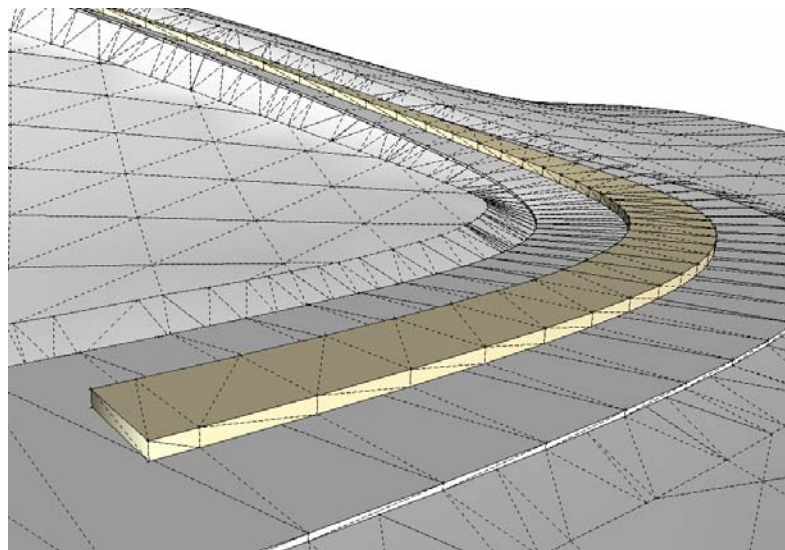

Median Height : 12

Raised Median Parameters

Median Height:	12
Merge with road surface?	no
if 'yes', enter Merging Width	1'
Break median at breaks in road surface?	No - use edge breaks in outline face
Smooth bumps?	no

OK Cancel

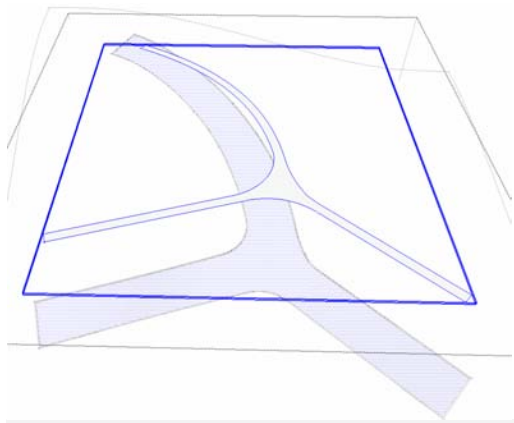

For the next 2 parameters, make a road surface and a median outline face with an intersection. The road surface must be active and the face must be in a group.

Select the group plus the road surface and choose **“Plugins/ Instant Road/ Make Island or Median”**.

Make Island or Median

Type of Island or Median:

Edit Additional Parameters?:

Merge with road surface? : no

Curb or Sidewalk Parameters

Curb Height:

Curb or sidewalk Width:

Median Height or Depression +/-:

Merge with road surface?:

if 'yes', enter Merging Width:

Break median at breaks in road surface?:

Smooth bumps?:

Under some conditions, the road surfaces won't align with the bottom of the median as shown here. The solution uses the next parameter:

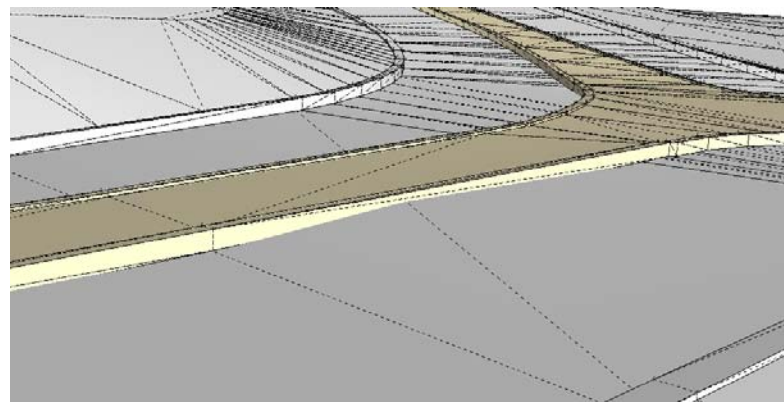
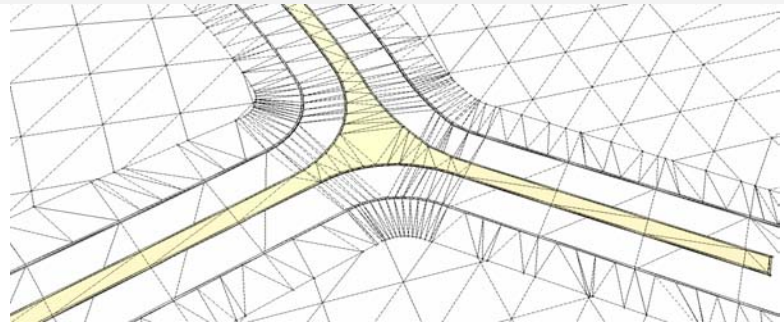

Merge with road surface? : yes
If 'yes', enter Merging Width : 48

Curb or Sidewalk Parameters

Curb Height:

Curb or sidewalk Width:

Median Height or Depression +/-:

Merge with road surface?:

if 'yes', enter Merging Width:

Break median at breaks in road surface?:

Smooth bumps?:

Now the road surface has been aligned with the bottom of the median.
Why not always Merge with road surface? Because it adds more polygons to the model.

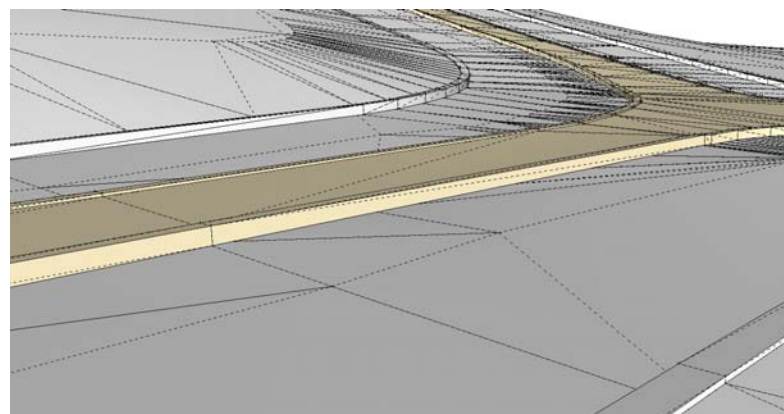
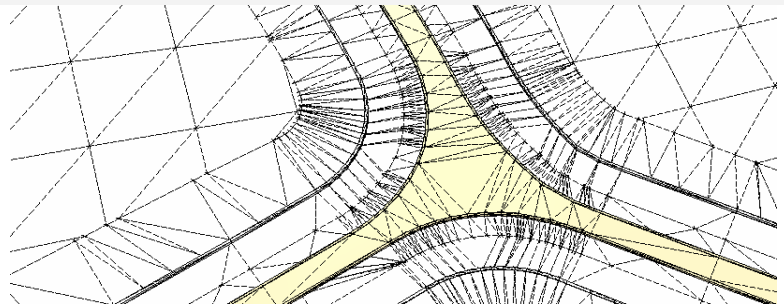

Smooth bumps? : no

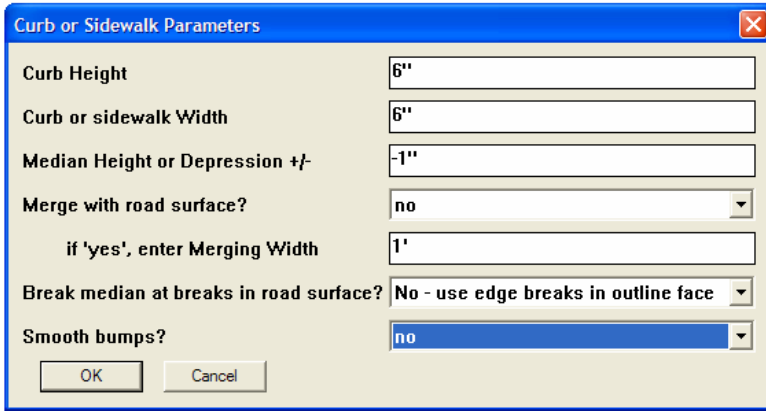

The screenshot shows a dialog box titled "Curb or Sidewalk Parameters" with a close button (X) in the top right corner. The parameters are as follows:

Curb Height	6"
Curb or sidewalk Width	6"
Median Height or Depression +/-	-1"
Merge with road surface?	no
if 'yes', enter Merging Width	1'
Break median at breaks in road surface?	No - use edge breaks in outline face
Smooth bumps?	no

At the bottom, there are "OK" and "Cancel" buttons.

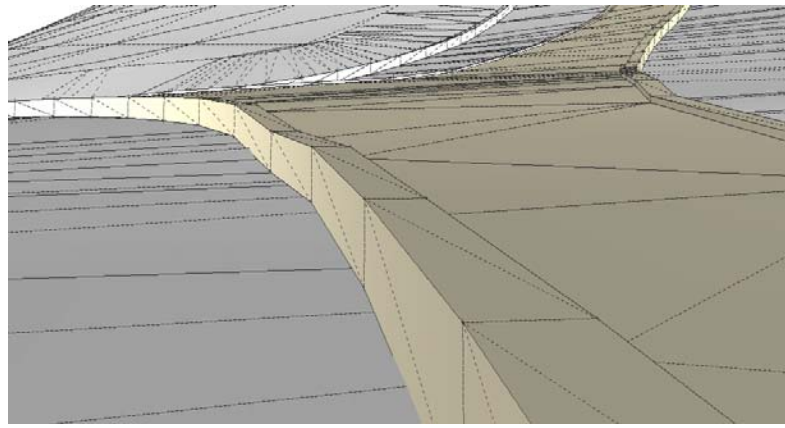

Under some conditions, the median will have an undulating top surface. The solution uses the next parameter:

Smooth bumps? : yes

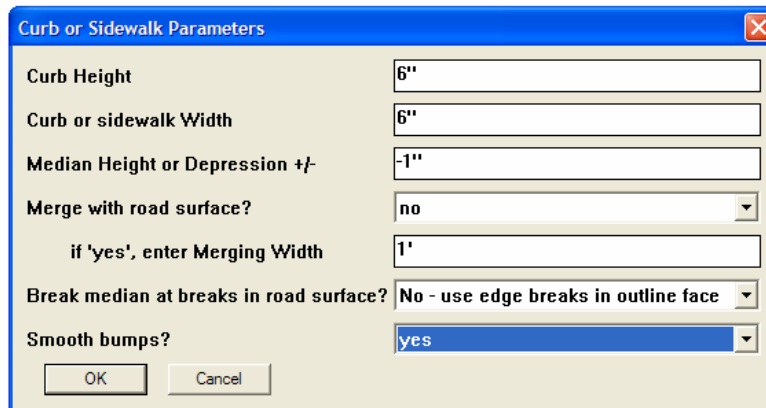

The screenshot shows the same "Curb or Sidewalk Parameters" dialog box, but with the "Smooth bumps?" parameter set to "yes".

Curb Height	6"
Curb or sidewalk Width	6"
Median Height or Depression +/-	-1"
Merge with road surface?	no
if 'yes', enter Merging Width	1'
Break median at breaks in road surface?	No - use edge breaks in outline face
Smooth bumps?	yes

At the bottom, there are "OK" and "Cancel" buttons.

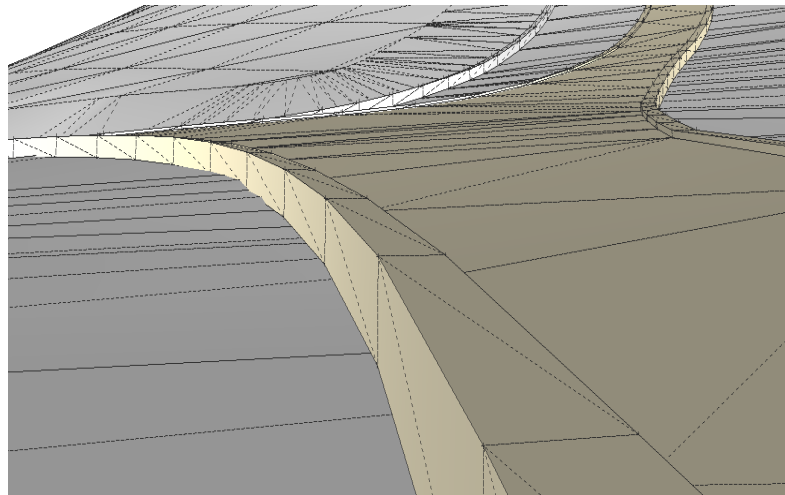

Why not always use the "Smooth bumps" parameter? Because undesired vertical curve flattening can occur.

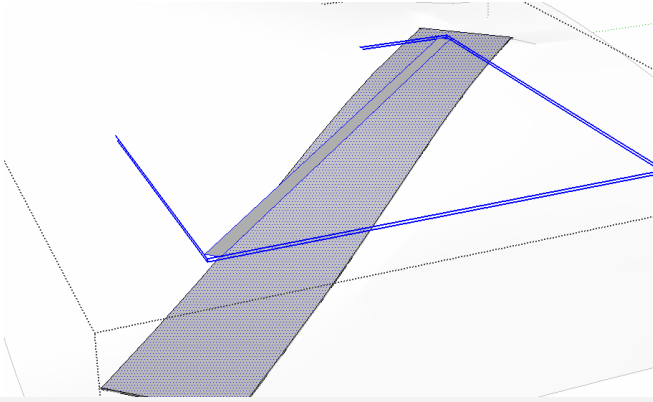

For the next parameter, make a road surface and a median outline face. The median outline face should have no edge breaks or fewer edge breaks than the road surface. The road surface must be active and the face must be in a group.

Select the group plus the road surface and choose **Choose "Plugins/ Instant Road / Make Island or Median"**.

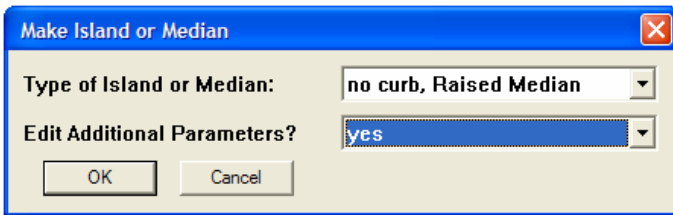

Break median at breaks in road surface? :
No - use edge breaks in outline face

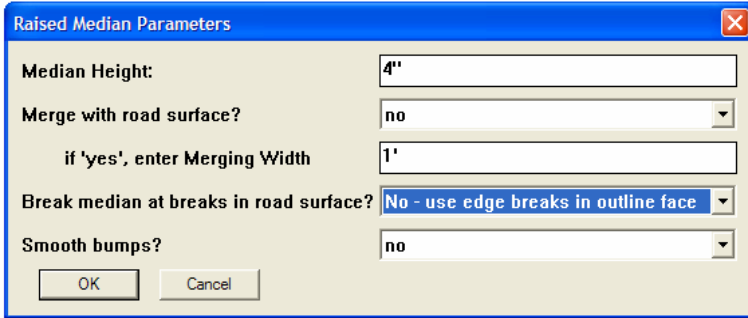
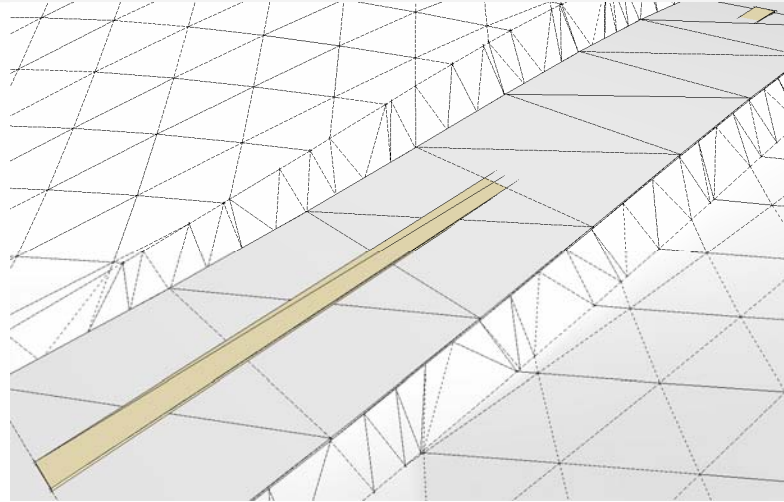

Break median at breaks in road surface? :
No - use edge breaks in outline face

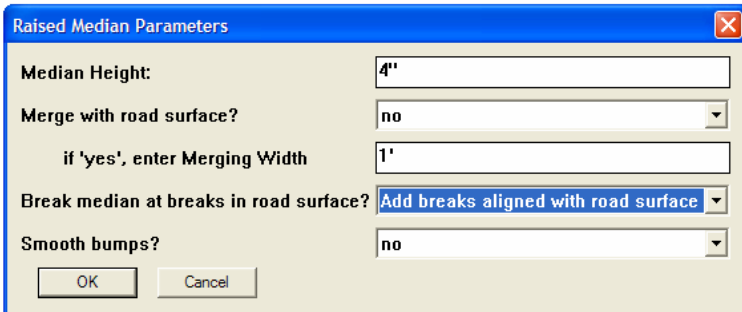

*Why not always use the Add breaks parameter?
 Because, especially around curves, an uneven top surface can result if the precision of the median significantly exceeds that of the road surface.*

